

安装示意图 Installation drawing

碳管加工示意 Carbon tube processing diagram

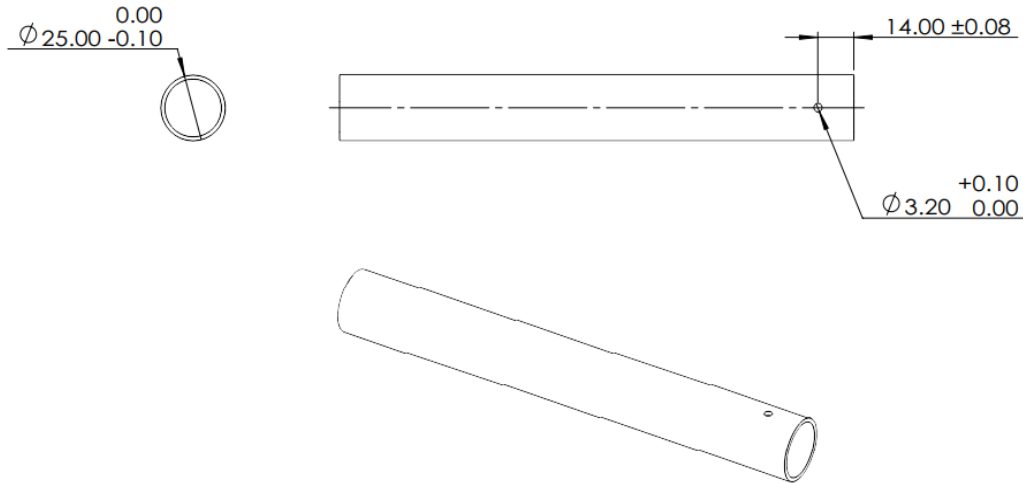

动力套装配示意 Assembly diagram

1. Unpack the standard kit, which contains four M3-10 carbon tube locking screws and one M3-6 carbon tube locating screw.

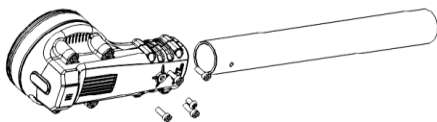

2. Insert the carbon tube to the bottom and pre-lock the four M3-10 carbon tube locking screws.

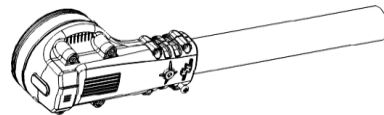

3. Lock the carbon tube positioning screws; (If the positioning screws can not be installed in place, it means that the holes are not aligned do not force screwing in. Screws need to be pre-coated before locking the screw glue, coated in the tail of the screw 3-8 teeth; screw locking torque of 8kgf*cm)

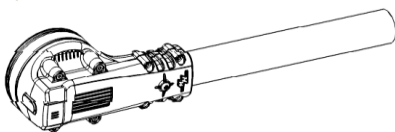

4. Lock the four M3-10 carbon tube locking screws; (screws need to be pre-coated with screw adhesive before locking, coated on the tail of the screws at 3-8 teeth; screw locking torque of 12.5kgf*cm)

