

## XR0TOR-2807SL 1700KV Specification (规格)

Rated Voltage (LiPo) 工作额定电压 (LiPo)	3-4S	KV KV值	1700KV
No-Load Current 空载电流	2.13A/16V	Resistance 相间内阻	37.5mΩ
Maximum Continuous Current 最大连续电流	53.9A/13s	Motor Weight 电机重量	58.4g
Maximum Continuous Rating 最大连续功率	864W/13s	Pole/Slot 槽极数	12N14P
Maximum propeller pull 最大螺旋桨拉力	2205g	Motor Lead Type 线号	18AWG
Motor Size 电机尺寸	Φ 34 *20.5mm	Motor Lead Length 出线长度	200mm
Shaft Diameter 出轴直径	D5+H5	Enamelled Wire Insulation Class 漆包线绝缘等级	耐200°C高温 H级
Shaft Length 出轴长度	15mm	Recommended ESC 推荐电调	XRotor FPV-62-65A-4in ECS
Screw Diameter / Thread 底座螺纹	Φ 19mm-4*M3	Propeller 螺旋桨	3-4S:HQ7x3.5x3, HQ7x4x3

## Load Performance 负载性能参数

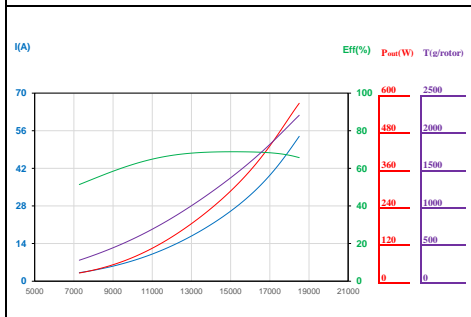
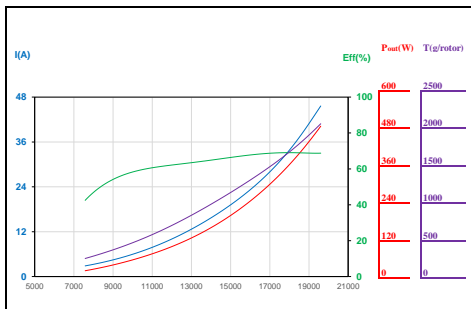

Voltage(V) 工作电压	Propeller 螺旋桨	Throttle (%) 油门	Thrust(g) 拉力	Current(A) 电流	Power(W) 输入功率	Speed(RPM) 转速	Efficiency(g/W) 效率	Recommended full load continuous running time 推荐满载油门连续运行时间
16V (4S Lipo)	HQ7x3.5x3 Propeller	40%	404	4.9	79	9342	5.10	40s
		50%	628	8.6	137	11353	4.57	
		60%	885	13.3	213	13211	4.16	
		70%	1173	19.2	309	15015	3.80	
		80%	1491	27.0	432	16799	3.45	
		90%	1825	36.5	585	18397	3.12	
		100%	2129	45.6	731	19601	2.91	
16V (4S Lipo)	HQ7x4x3 Propeller	40%	453	5.8	92	9085	4.91	20s
		50%	695	10.2	163	11030	4.26	
		60%	959	15.8	253	12742	3.78	
		70%	1253	22.9	367	14381	3.41	
		80%	1586	32.1	514	16007	3.08	
		90%	1934	43.5	697	17463	2.78	
		100%	2205	53.9	864	18503	2.55	

The above data is measured at room temperature 25° C and sea level height. If the throttle input adjustment tensile force is measured, the full-load full throttle running time should be controlled, otherwise there is a risk of burning the motor.  
(以上数据为室温 25° C、海平面高度的环境下,变化油门输入调节拉力测得,应控制满载全油门运行时间,否则有烧毁电机的危险。)

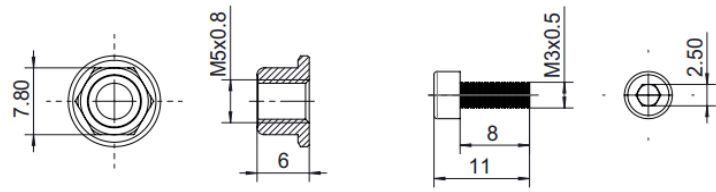
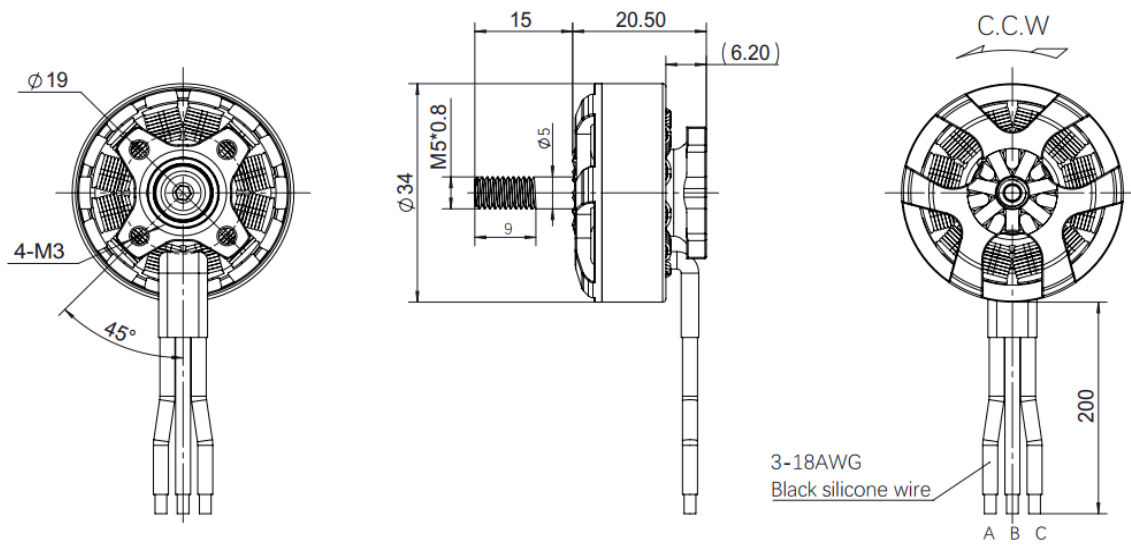

2807SL